

Band Clamp Filters

Harmsco® Band Clamp Filters Utilize Patented Up-Flow Filtration While Simplifying Installation and Maintenance.



Models BC4-1, BC4-2, BC4-3, BC6-1, BC6-2, BC6-3

STANDARD FEATURES & SPECIFICATIONS

- 304 stainless steel filter housings for increased durability
- Electro polished for superior finish
- Band clamp lid closure
- Staggered in-line installation
- O-Rings - Buna-N
- Removable cartridge lifters for easy cartridge removal
- Stainless cartridge lifters
- Maximum Operating Pressure: 150 psi
- Uses Harmsco & popular length cartridges
- Integral mounting legs
- Cartridge specifications always prevail

AVAILABLE OPTIONS

- Chemical resistant coatings
- O-Rings - Viton & EPDM
- BSTP or Victaulic options
- Private labeling available for volume orders
- High temperature applications require Viton O-Ring and stainless steel threaded tightening nut
- 316 stainless steel



HARMSCO® Filtration Products

www.harmsco.com

P.O. Box 14066, North Palm Beach, FL 33408 (561) 848-9628

Toll-free: (800) 327-3248 • Fax: (561) 845-2474 • E-mail: sales@harmsco.com

MADE IN U.S.A.



TECHNICAL DATA

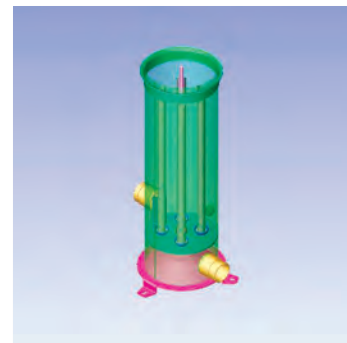
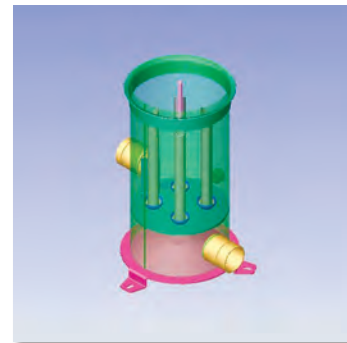
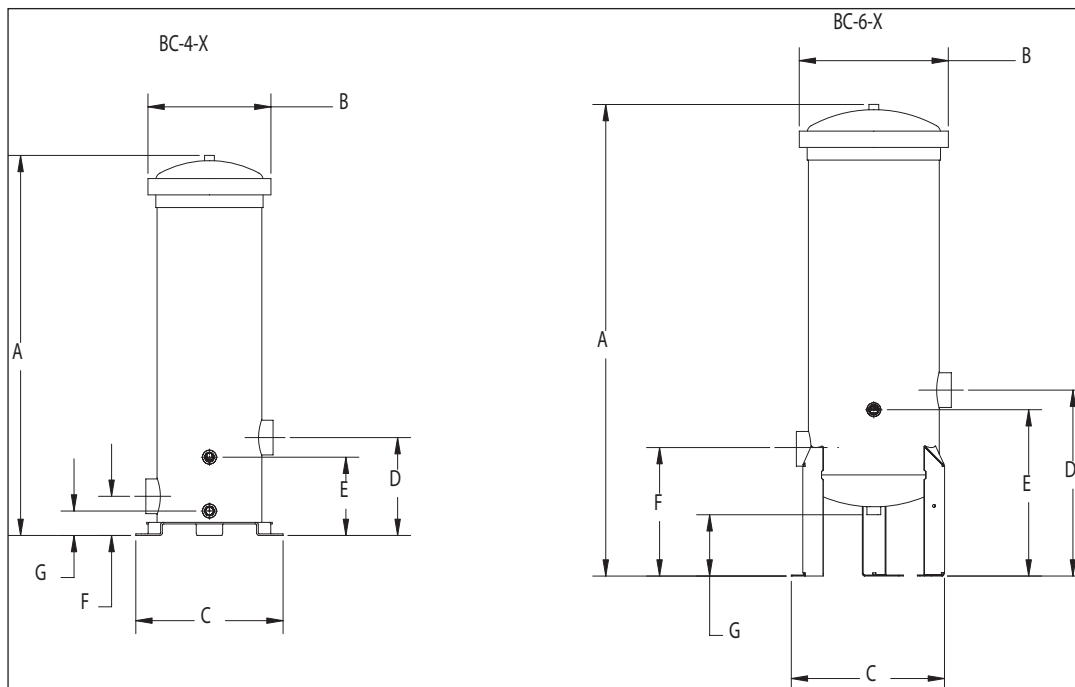

Model	A-Height	B-Diameter	C-Width	D-Height	E-Height	F-Height	G-Height
BC-4-1	19-1/2"	9-1/2"	11-1/2"	7-1/2"	6"	3"	1-7/6"
BC-4-2	29-1/4"	9-1/2"	11-1/2"	7-1/2"	6"	3"	1-7/6"
BC-4-3	39"	9-1/2"	11-1/2"	7-1/2"	6"	3"	1-7/6"
BC-6-1	25-1/2"	11-1/2"	12"	14-1/4"	12-3/4"	9-3/4"	4-3/4"
BC-6-2	35-1/4"	11-1/2"	12"	14-1/4"	12-3/4"	9-3/4"	4-3/4"
BC-6-3	45"	11-1/2"	12"	14-1/4"	12-3/4"	9-3/4"	4-3/4"

MODELS AND INDIVIDUAL SPECIFICATIONS

MODEL	Conservative Recommended Flow Rate	Max GPM Flow Rate*	LMP Flow Rate	(M3/hr) Flow Rate	Media Area W/ Harmsco 801 cartridge**	Cartridge Height	Service Height	Shipping Weight
BC4-1	12	up to 25	95	5	24 sq. ft.	9 3/4"-10"	28"	27 lbs
BC4-2	24	up to 50	190	12	48 sq. ft.	19 1/2"-20"	47"	32 lbs
BC4-3	36	up to 75	285	17	72 sq. ft.	29 1/4"-30"	67"	38 lbs
BC6-1	18	up to 42	159	10	36 sq. ft.	9 3/4"-10"	28"	45 lbs
BC6-2	36	up to 84	318	19	72 sq. ft.	19 1/2"-20"	47"	53 lbs
BC6-3	54	up to 126	477	29	108 sq. ft.	29 1/4"-30"	67"	62 lbs

All Band Clamp Models: Temp Rating 300° * | I/O Pipe Size 2" | Drain Size 1/2"**

* Flow rates should be used as guidelines; actual flow rates will vary based on many different factors.

** 6 sq. ft. cartridges. *** Cartridge specifications always prevail.

Floor Space Footprint:

BC-4-x: 13" x 13"; BC-6-x: 15" x 15"

Some of the information contained in this publication has been obtained from outside sources and is considered accurate. Temperature ratings, flow rates and chemical resistance can be affected by a number of unknown factors. For this reason, we do not assume any liability for the accuracy or completeness of the data in this publication. End users should perform their own tests to determine suitability for each application.



HARMSCO® Filtration Products

www.harmsco.com

P.O. Box 14066, North Palm Beach, FL 33408 (561) 848-9628

Toll-free: (800) 327-3248 • Fax: (561) 845-2474 • E-mail: sales@harmsco.com

MADE IN U.S.A.



011 4/07